

# LAMBERT

## HDW3881C TRAILING SWEEPER

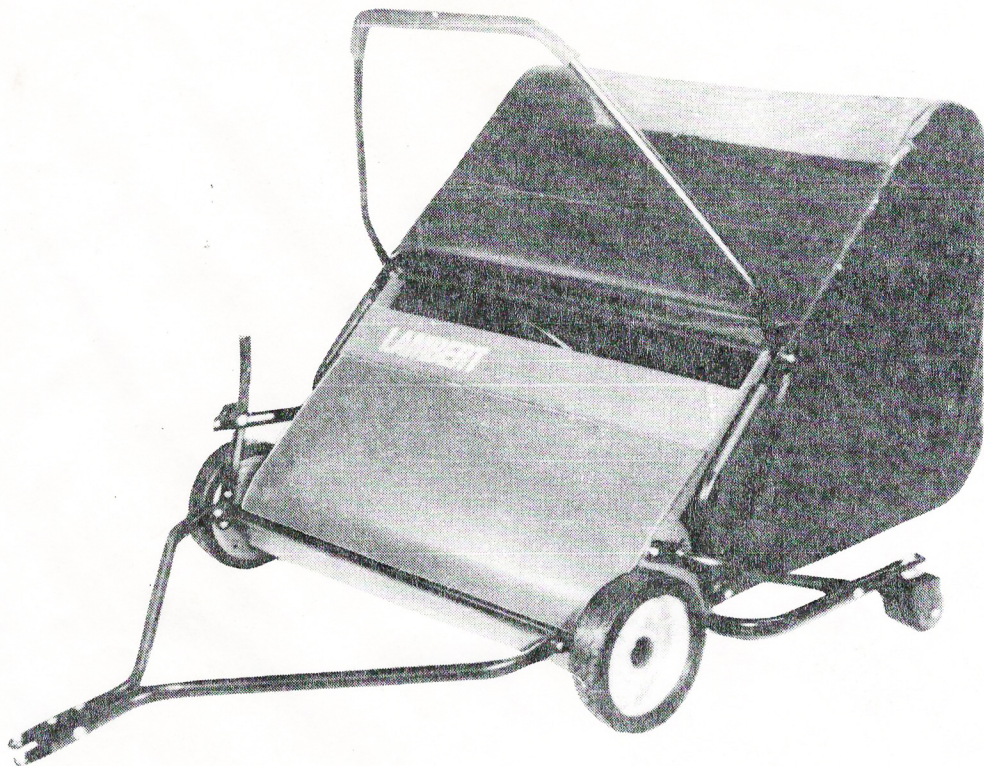

2510

OPERATOR'S MANUAL AND PARTS LIST



# REPAIR PARTS LIST

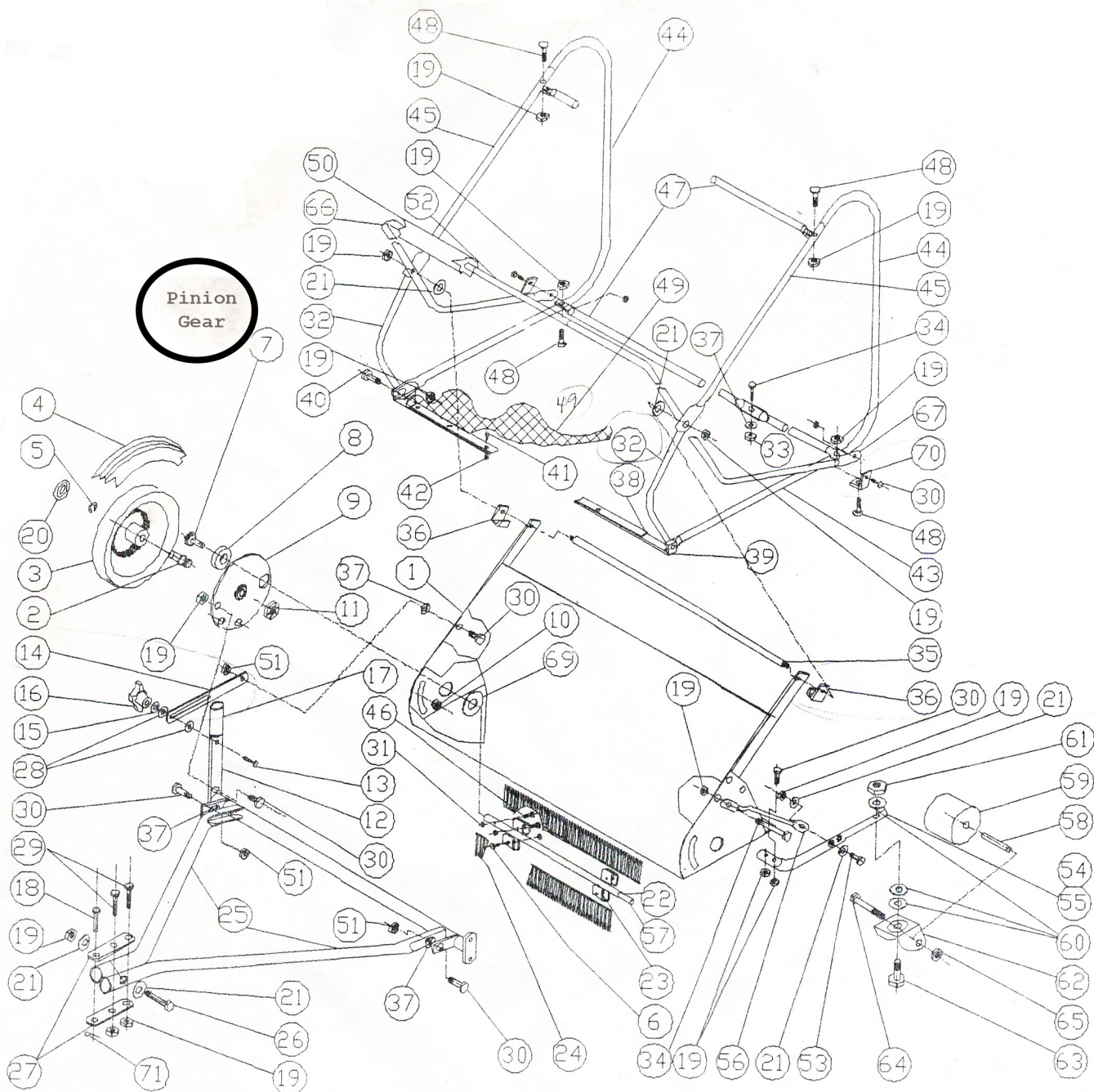

KEY	PART DESCRIPTION	HDW3881C PART NO.	QTY
60	1/2 Flat Washer .....	L-64A .....	6
61	1/2-13 Hex Center Lock Nut .....	X-1353 .....	2
62	Caster Yoke Assembly .....	1A-B2899 .....	2
63	1/2-13 x 1 3/4 Cap Screw .....	X-1480 .....	2
64	3/8-16 x 4 1/2 Cap Screw .....	X-1439 .....	2
65	3/8-16 Lock Nut .....	X-1623 .....	2
66	Dump Handle -Right Hand .....	1-C3078 .....	1
67	Dump Handle-Left Hand .....	1-C3079 .....	1
69	Brush Axle Washer .....	X-1674 .....	2
70	Dump Handle Bracket .....	1-A3084 .....	2
71	Hair Pin .....	L-298 .....	1



# REPAIR PARTS LIST

KEY	Product Description	HDW3881C PART NO.	QTY
1	Chassis Assembly .....	1A-D3076 .....	1
2	Wheel Stud .....	L-5749 .....	2
3	Wheel Assembly .....	1A-C2931 .....	2
4	Tire .....	1-C2790 .....	2
5	Retaining Ring .....	L-262 .....	2
6	1/4-20 x 3/4 Cap Screw .....	L-172 .....	8
7	Pinion Gear .....	1A-A2870 .....	2
8	Bearing .....	1-A3073 .....	2
9	Wheel Shield .....	1-B3072 .....	2
10	3/8-24 Pilot Nut .....	L-5485 .....	2
11	3/8-24 Lock Nut .....	L-5486M .....	2
12	Height Adjustment Lever Assembly .....	1A-C3086 .....	1
13	3/8-16 x 1 Carriage Bolt .....	X-2002 .....	1
14	Height Adjustment Strap .....	1-A3152 .....	1
15	3/8 Flat Washer .....	L-64 .....	1
16	3/8-16 Knob .....	9-A2002 .....	1
17	Handle Grip .....	16-3080B .....	1
18	Hitch Pin .....	X-1382 .....	1
19	5/16-18 Lock Nut .....	X-1622 .....	25
20	Hub Cap .....	L-5471B .....	2
21	5/16 Flat Washer .....	L-99 .....	8
22	Brush Axle Assembly .....	1A-B3006 .....	2
23	Brush Clamp .....	1-A2873 .....	8
24	Brush Strip .....	1-B3067 .....	4
25	Hitch Tube .....	1-D3066 .....	2
26	5/16-18 x 2 3/4 Cap Screw .....	X-1511 .....	1
27	Flat Hitch Bracket .....	1-A2828 .....	2
28	Rubber Washer .....	X-1673 .....	2
29	5/16-18 x 2 1/4 Cap Screw .....	X-1545 .....	2
30	5/16-18 x 3/4 Cap Screw .....	L-59 .....	13
31	1/4-20 Lock Nut .....	x-1621 .....	10
32	Hamper Tube - Front .....	1-C3077 .....	2
33	5/16-18 Hex Nut .....	L-60 .....	2
34	5/16-18 x 1 Cap Screw .....	L-80 .....	4
35	Tie Rod .....	1-A3142 .....	1
36	Hamper Latch .....	1-A3157 .....	2
37	5/16 Lock Washer .....	X-1025 .....	5
38	Hamper Strap .....	1-D3127 .....	1
39	Formed Hamper Strap .....	1-D3126 .....	1
40	5/16-18 x 1 1/4 Cap Screw .....	X-1655 .....	2
41	#10-24 x 1/2 Slotted Head Screw .....	X-1659 .....	7
42	#10-24 Lock Nut .....	L-242B .....	7
43	Hamper Tube - Bottom .....	1-D3131 .....	2
44	Hamper Tube - Back .....	1-D3166 .....	2
45	Hamper Tube - Top .....	1-D3177 .....	2
46	1/4-20 x 1 1/4 Cap Screw .....	X-1182 .....	2
47	Hamper Cross Tube .....	1-D3124 .....	4
48	5/16-18 x 1 1/2 Tube Bolt .....	X-1392 .....	4
49	Hamper Assembly .....	1A-D3081 .....	1
50	Dump Handle Foam Cover .....	1-A3080 .....	1
51	5/16-18 Pilot Nut .....	L-5552 .....	3
52	Dump Handle -Center Tube .....	1-A3139 .....	1
53	5/16-18 x 1 3/4 Cap Screw .....	X-1027 .....	2
54	Caster Tube - Right Hand (Not Shown) .....	1-C3087 .....	1
55	Caster Tube - Left Hand .....	1-C3088 .....	1
56	Caster Brace Tube .....	1A-C3089 .....	2
57	Brush Axle Center Shaft .....	1-A3016 .....	1
58	Caster Sleeve .....	1-A2512 .....	2
59	Caster Wheel .....	1-B2900 .....	2

# Instructions for Ordering Parts

**Note: Be sure to specify color (if any) of any parts you order.  
(Minimum Parts Order Charge \$2.50)**

To eliminate error and speed delivery, follow these suggestions:

1. Address all parts orders to:

Parts Department	(937) 337-3641
Mid West Products, Inc.	(937) 337-0755 FAX
PO Box 301	<a href="mailto:parts@mid-west-products-inc.com">parts@mid-west-products-inc.com</a>
Phillipsburg, OH 45354	<a href="http://www.mid-west-products-inc.com">www.mid-west-products-inc.com</a>

2. Write your name and address plainly (print or type).

3. Explain where and how to ship.

4. Give model and serial number taken from the sweeper chassis.

5. Give part number from list on back page, as well as a description of the part and the quantity you need of each part.

6. Inspect all shipments you receive. If any parts are damaged or missing, file a claim with the carrier before accepting.

7. If you are returning parts, be sure to include WITH THE SHIPMENT a list of the parts with your name and address. All returned parts must be sent prepaid to:

Parts Department	(937) 337-3641
Mid West Products, Inc.	(937) 337-0755 FAX
PO Box 301	<a href="mailto:parts@mid-west-products-inc.com">parts@mid-west-products-inc.com</a>
Phillipsburg, OH 45354	<a href="http://www.mid-west-products-inc.com">www.mid-west-products-inc.com</a>

8. All orders for repair and replacement parts will be shipped C.O.D. This is not a reflection on your credit standing, but a bookkeeping necessity. Prices are subject to change without notice.